

# EUROCRAFT INDUSTRIES INC.

## 88MD LIFT AND SLIDE DOOR

### (HVHZ)(IMPACT)

GENERAL NOTES:

1. THE PRODUCT SHOWN HEREIN IS DESIGNED AND MANUFACTURED TO COMPLY WITH THE CURRENT EDITION FLORIDA BUILDING CODE (FBC), INCLUDING HVHZ AND HAS BEEN EVALUATED ACCORDING TO THE FOLLOWING:
  - TAS 201-94
  - TAS 202-94
  - TAS 203-94
2. ADEQUACY OF THE EXISTING STRUCTURAL CONCRETE/MASONRY, 2X FRAMING, AND METAL FRAMING AS A MAIN WIND FORCE RESISTING SYSTEM CAPABLE OF WITHSTANDING AND TRANSFERRING APPLIED PRODUCT LOADS TO THE FOUNDATION IS THE RESPONSIBILITY OF THE ENGINEER OR ARCHITECT OF RECORD FOR THE PROJECT OF INSTALLATION.
3. 1X AND 2X BUCKS (WHEN USED) SHALL BE DESIGNED AND ANCHORED TO PROPERLY TRANSFER ALL LOADS TO THE STRUCTURE. BUCK DESIGN AND INSTALLATION IS THE RESPONSIBILITY OF THE ENGINEER OR ARCHITECT OF RECORD FOR THE PROJECT OF INSTALLATION.
4. INSTALL INDIVIDUAL INSTALLATION ANCHORS WITHIN A TOLERANCE OF ±1/4 INCH OF THE DEPICTED LOCATION IN THE ANCHOR LAYOUT DETAIL (I.E., WITHOUT CONSIDERATION OF TOLERANCES). TOLERANCES ARE NOT CUMULATIVE FROM ONE INSTALLATION ANCHOR TO THE NEXT.
5. THE INSTALLATION DETAILS DESCRIBED HEREIN ARE GENERIC AND MAY NOT REFLECT ACTUAL CONDITIONS FOR A SPECIFIC SITE. IF SITE CONDITIONS CAUSE INSTALLATION TO DEVIATE FROM THE REQUIREMENTS DETAILED HEREIN, A LICENSED ENGINEER OR ARCHITECT SHALL PREPARE SITE SPECIFIC DOCUMENTS FOR USE WITH THIS DOCUMENT IN NON-HVHZ AREAS. IN HVHZ AREAS, ONE TIME PRODUCT APPROVAL TO BE OBTAINED FROM MIAMI-DADE RER OR AHJ.
6. APPROVED IMPACT PROTECTIVE SYSTEM **IS NOT REQUIRED** ON THIS PRODUCT IN AREAS REQUIRING IMPACT RESISTANCE.
7. WINDOW FRAME MATERIAL: VINYL U-PVC
8. GLASS MEETS THE REQUIREMENTS OF ASTM E 1300 GLASS CHARTS. SEE SHEET 1 FOR GLAZING DETAILS.
9. APPROVED CONFIGURATIONS:  
2 PANEL - OX, XO, XX  
3 PANEL - XOx, OXO, OXX, XXO  
4 PANEL - OXXO

| OVERALL SIZE |        | CONFIG. | DESIGN PRESSURE (DP) | MISSILE IMPACT RATING | GLAZING |
|--------------|--------|---------|----------------------|-----------------------|---------|
| WIDTH        | HEIGHT |         |                      |                       |         |
| 180"         | 96"    | OX      | +/- 55 PSF           | LMI                   | GLZ 5   |
| 144"         | 114"   | OXO     | +/- 55 PSF           | LMI                   | GLZ 5   |
| 240"         | 114"   | OXXO    | +/- 55 PSF           | LMI                   | GLZ 5   |
| 110"         | 120"   | OX      | +/- 120 PSF          | LMI                   | GLZ 1-4 |
| 168"         | 120"   | OXO     | +/- 120 PSF          | LMI                   | GLZ 1-4 |
| 220"         | 120"   | OXXO    | +/- 120 PSF          | LMI                   | GLZ 1-4 |

| TABLE OF CONTENTS |          |  |
|-------------------|----------|--|
| SHEET             | REVISION | SHEET DESCRIPTION                                  |
| 1                 | A        | INSTALLATION AND GENERAL NOTES                     |
| 2                 | A        | ELEVATIONS   |
| 3                 | A        | ELEVATION  |
| 4                 | A        | ANCHOR LAYOUTS                                     |
| 5                 | A        | VERTICAL SECTIONS                                  |
| 6                 | A        | HORIZONTAL SECTIONS                                |
| 7                 | A        | INSTALLATION NOTES, REINFORCEMENT & ANCHOR DETAILS |
| 8                 | A        | GLASS LOAD CAPACITIES                              |
| 9                 | A        | BILL OF MATERIALS                                  |

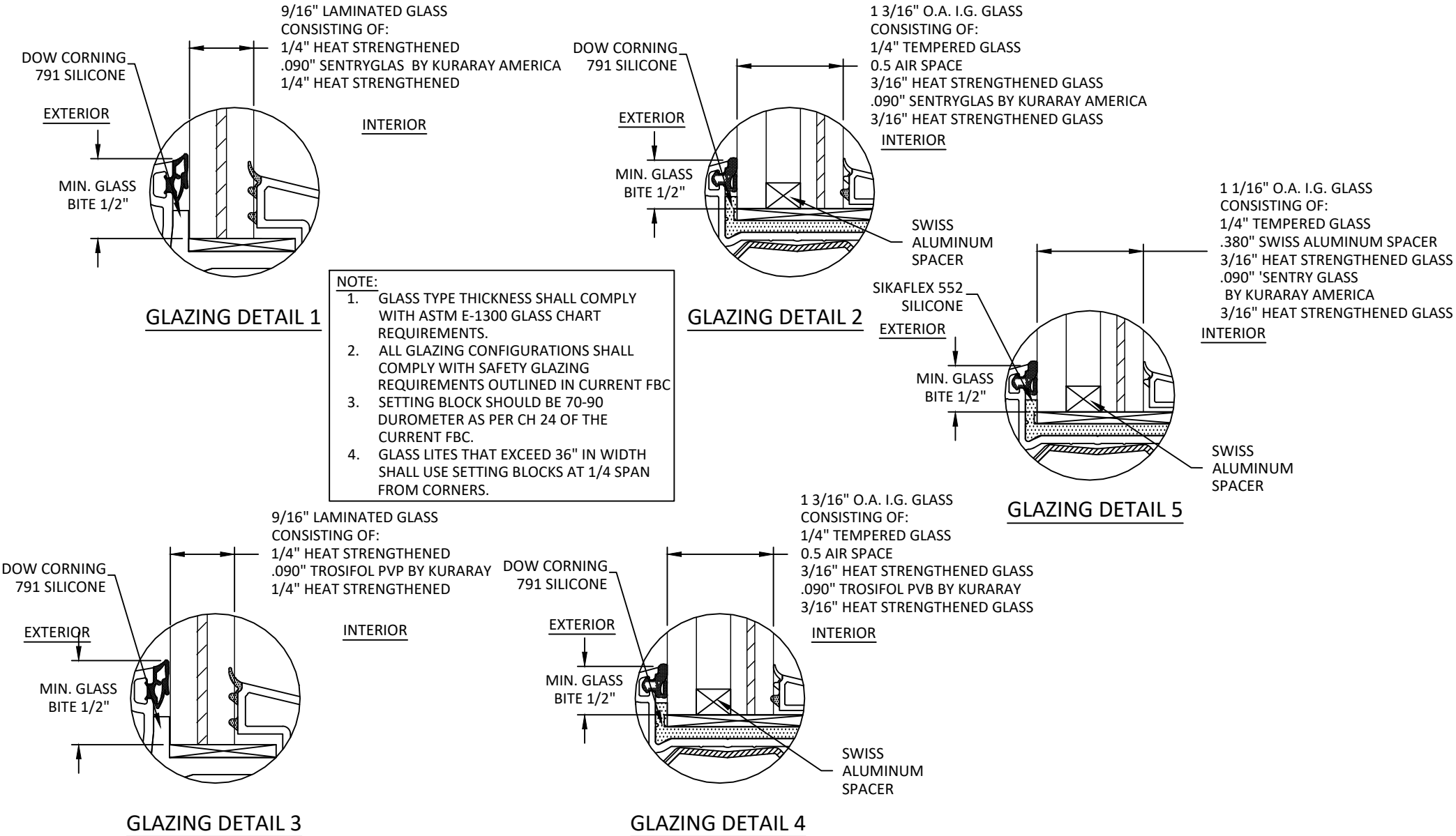

7905 NW 77TH AVE  
MEDLEY, FL 33166  
PH: (305) 888-5718 FX: (305) 220-5073

TITLE: 88MD LIFT AND SLIDE DOOR  
(HVHZ)(IMPACT)

INSTALLATION & GENERAL NOTES

PREPARED BY:

BUILDING DROPS, INC.  
398 E. DANIA BEACH BLVD., STE. 338  
DANIA BEACH, FL 33004  
PH: (954) 399-8478  
FAX: (954) 744-4738  
WEB: www.buildingdrops.com



| REMARKS            | BY | DATE  |
|--------------------|----|-------|
| A-CODE CHANGE 2020 | YC | 09/20 |
|                    |    |       |
|                    |    |       |
|                    |    |       |

THE INSTALLATION DETAILS DESCRIBED HEREIN ARE GENERIC AND MAY NOT REFLECT ACTUAL CONDITIONS FOR A SPECIFIC SITE. IF SITE CONDITIONS CAUSE INSTALLATION TO DEVIATE FROM THE REQUIREMENTS DETAILED HEREIN, A LICENSED ENGINEER OR ARCHITECT SHALL PREPARE SITE SPECIFIC DOCUMENTS FOR USE WITH THIS DOCUMENT.

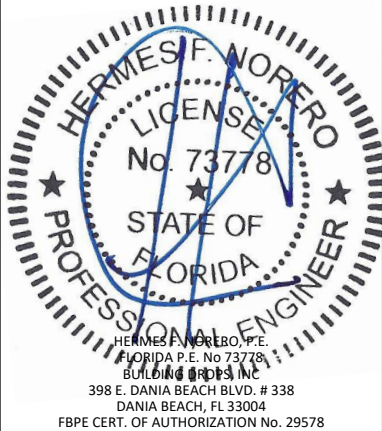

FL #:  
**FL12092**

DATE: **09.29.2020**

DWG. BY: **YC** CHK. BY: **HFN**

SCALE: **NTS**

DWG. #: **ECI010**

SHEET:

**1**

OF 9

1/11/2021 12:42 PM  
c:\users\p50\onedrive - building drops, inc\ec010.dwg

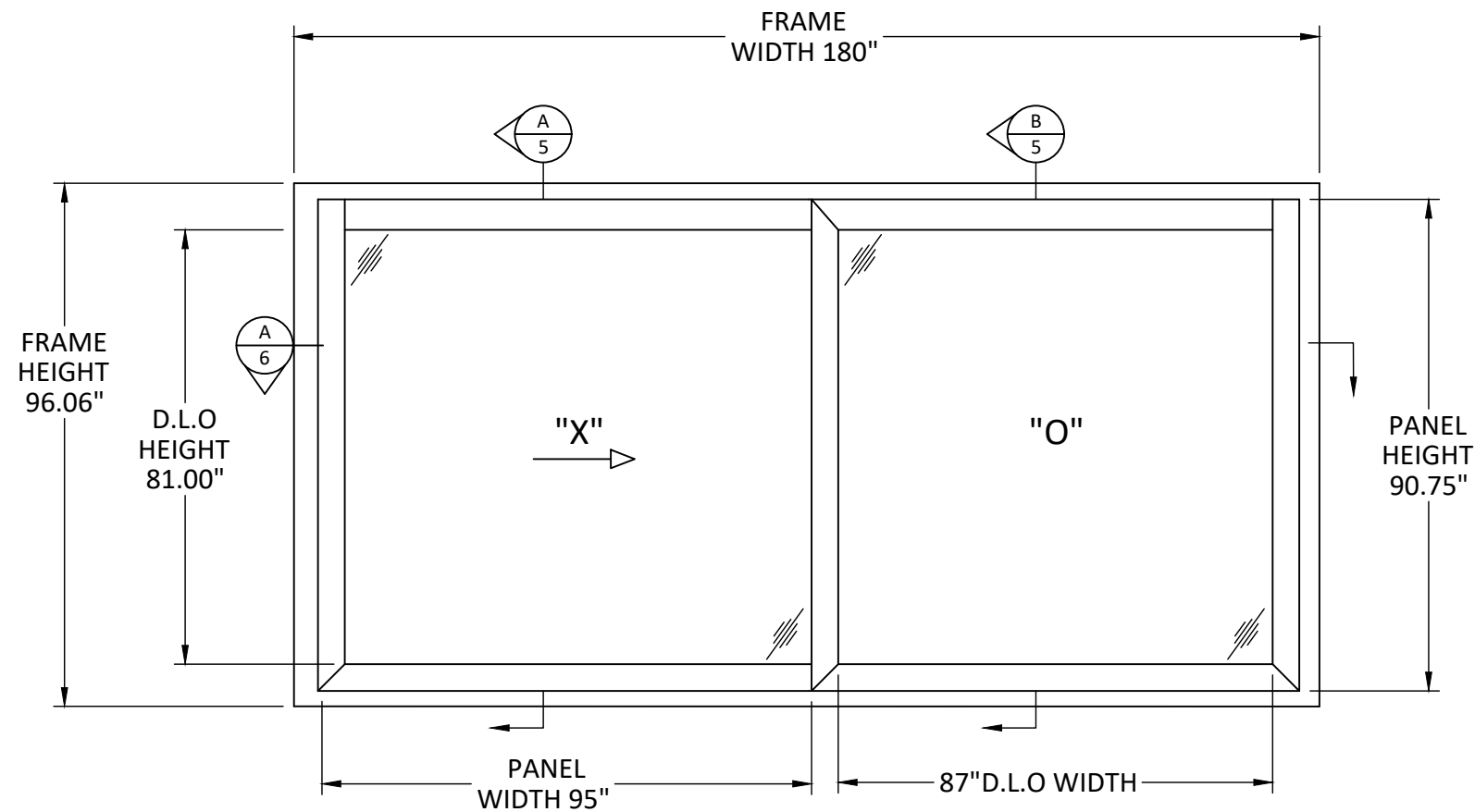

**ELEVATION**  
LIFT AND SLIDE DOOR

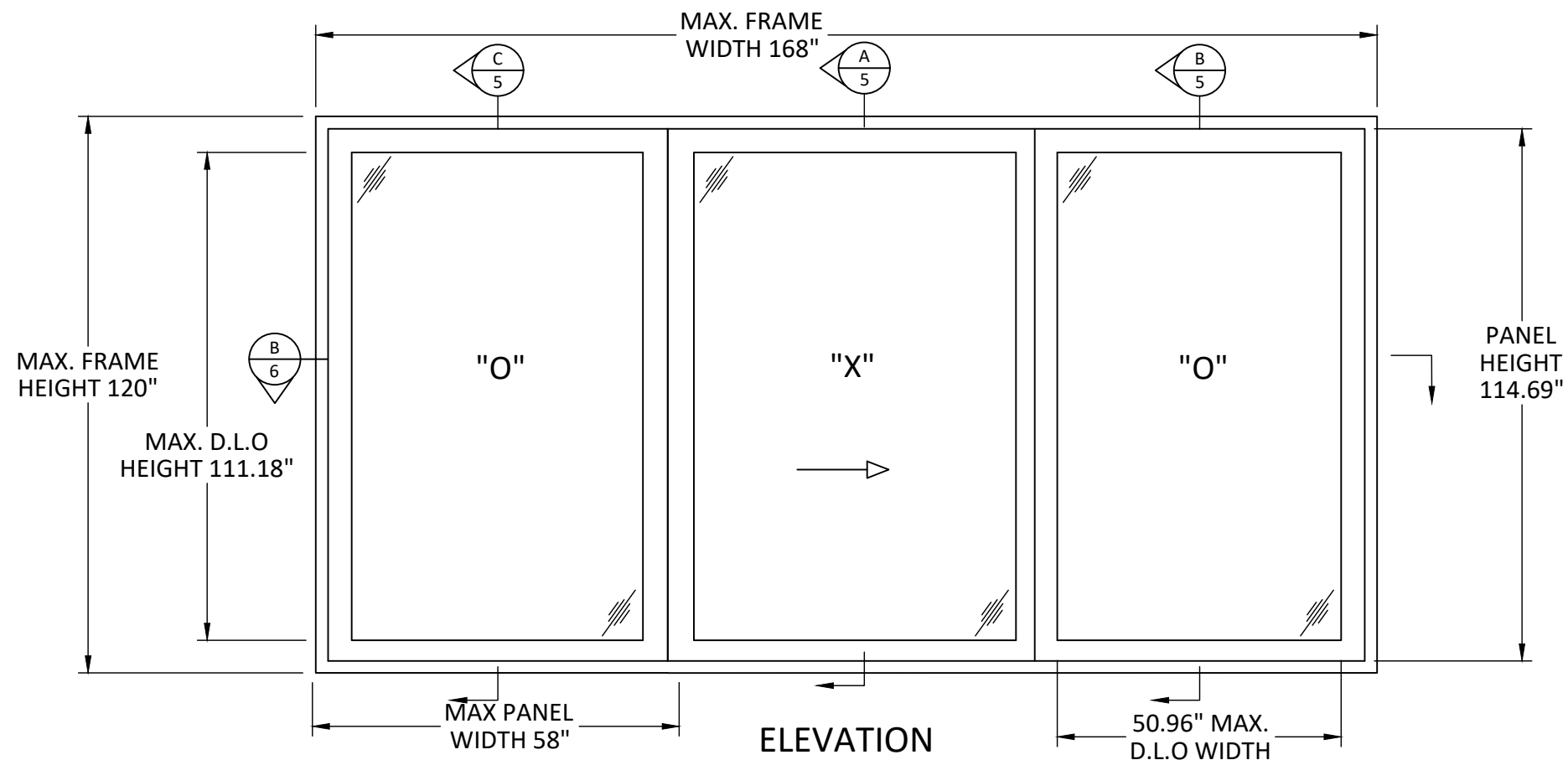

**ELEVATION**  
LIFT AND SLIDE DOOR



7905 NW 77TH AVE  
MEDLEY, FL 33166  
PH: (305) 888-5718 FX: (305) 220-5073

TITLE: 88MD LIFT AND SLIDE DOOR  
(HVHZ)(IMPACT)

ELEVATIONS

PREPARED BY:

**BUILDING DROPS, INC.**  
398 E. DANIA BEACH BLVD., STE. 338  
DANIA BEACH, FL 33004  
PH: (954) 999-8478  
FAX: (954) 744-4738  
WEB: www.buildingdrops.com



| REMARKS            | BY | DATE  |
|--------------------|----|-------|
| A-CODE CHANGE 2020 | YC | 09/20 |
|                    |    |       |
|                    |    |       |
|                    |    |       |

THE INSTALLATION DETAILS DESCRIBED HERE IN ARE GENERIC AND MAY NOT REFLECT ACTUAL CONDITIONS FOR A SPECIFIC SITE. IF SITE CONDITIONS CAUSE INSTALLATION TO DEVIATE FROM THE REQUIREMENTS DETAILED HEREIN, A LICENSED ENGINEER OR ARCHITECT SHALL PREPARE SITE SPECIFIC DOCUMENTS FOR USE WITH THIS DOCUMENT.

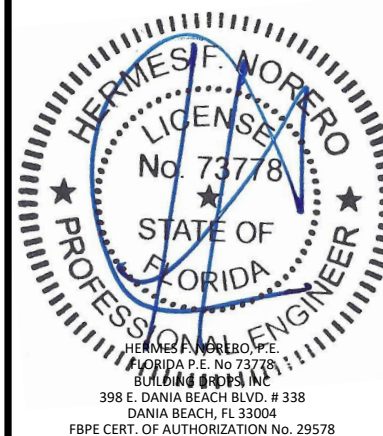

FL #:  
**FL12092**

DATE: **09.29.2020**

DWG. BY: **YC** CHK. BY: **HFN**

SCALE: **NTS**

DWG. #: **ECI010**

SHEET:

**2**

OF 9

c:\users\p50\onedrive - building drops, inc\ec010.dwg 1/11/2021 12:42 PM

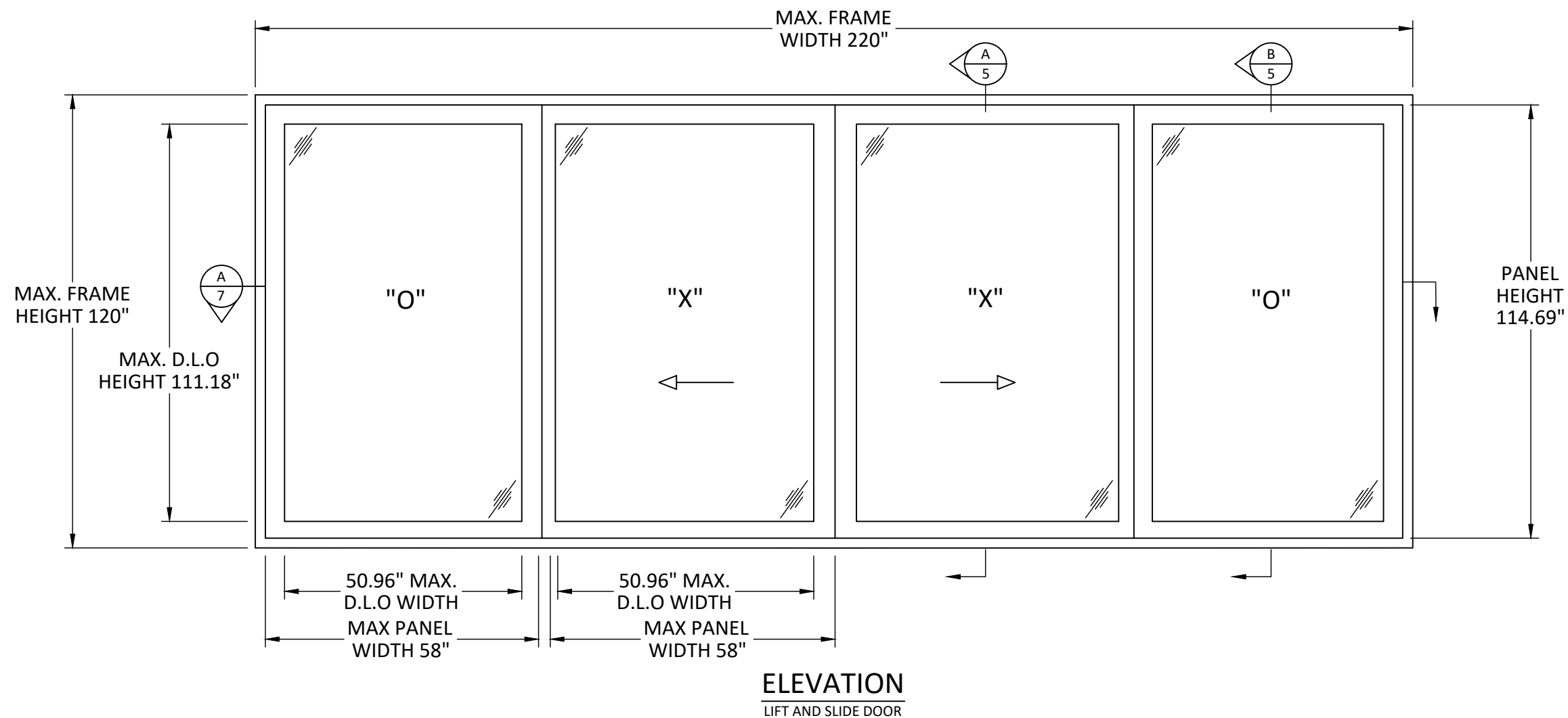

7905 NW 77TH AVE  
MEDLEY, FL 33166  
PH: (305) 888-5718 FX: (305) 220-5073

TITLE: 88MD LIFT AND SLIDE DOOR  
(HVHZ)(IMPACT)

ELEVATION

PREPARED BY:  
BUILDING DROPS, INC.  
398 E. DANIA BEACH BLVD., STE. 338  
DANIA BEACH, FL 33004  
PH: (954) 399-8478  
FAX: (954) 744-4738  
WEB: www.buildingdrops.com



| REMARKS            | BY | DATE  |
|--------------------|----|-------|
| A-CODE CHANGE 2020 | YC | 09/20 |
|                    |    |       |
|                    |    |       |
|                    |    |       |

THE INSTALLATION DETAILS DESCRIBED HERE IN ARE GENERIC AND MAY NOT REFLECT ACTUAL CONDITIONS FOR A SPECIFIC SITE. IF SITE CONDITIONS CAUSE INSTALLATION TO DEVIATE FROM THE REQUIREMENTS DETAILED HEREIN, A LICENSED ENGINEER OR ARCHITECT SHALL PREPARE SITE SPECIFIC DOCUMENTS FOR USE WITH THIS DOCUMENT.

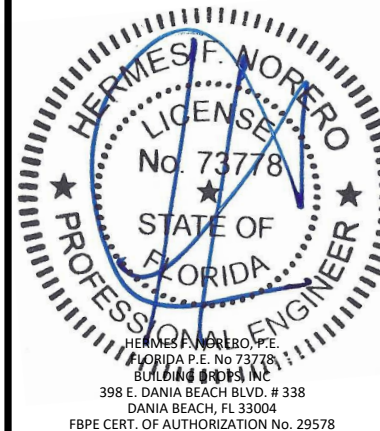

FL #:  
**FL12092**

DATE: **09.29.2020**

|                       |                        |
|-----------------------|------------------------|
| DWG. BY:<br><b>YC</b> | CHK. BY:<br><b>HFN</b> |
|-----------------------|------------------------|

SCALE: **NTS**

DWG. #: **ECI010**

SHEET:  
**3**

OF 9

1/11/2021 12:42 PM

c:\users\p50\onedrive - building drops, inc\eci010.dwg

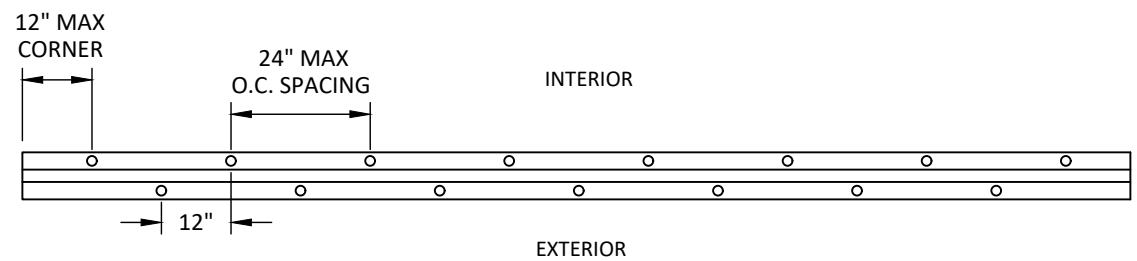
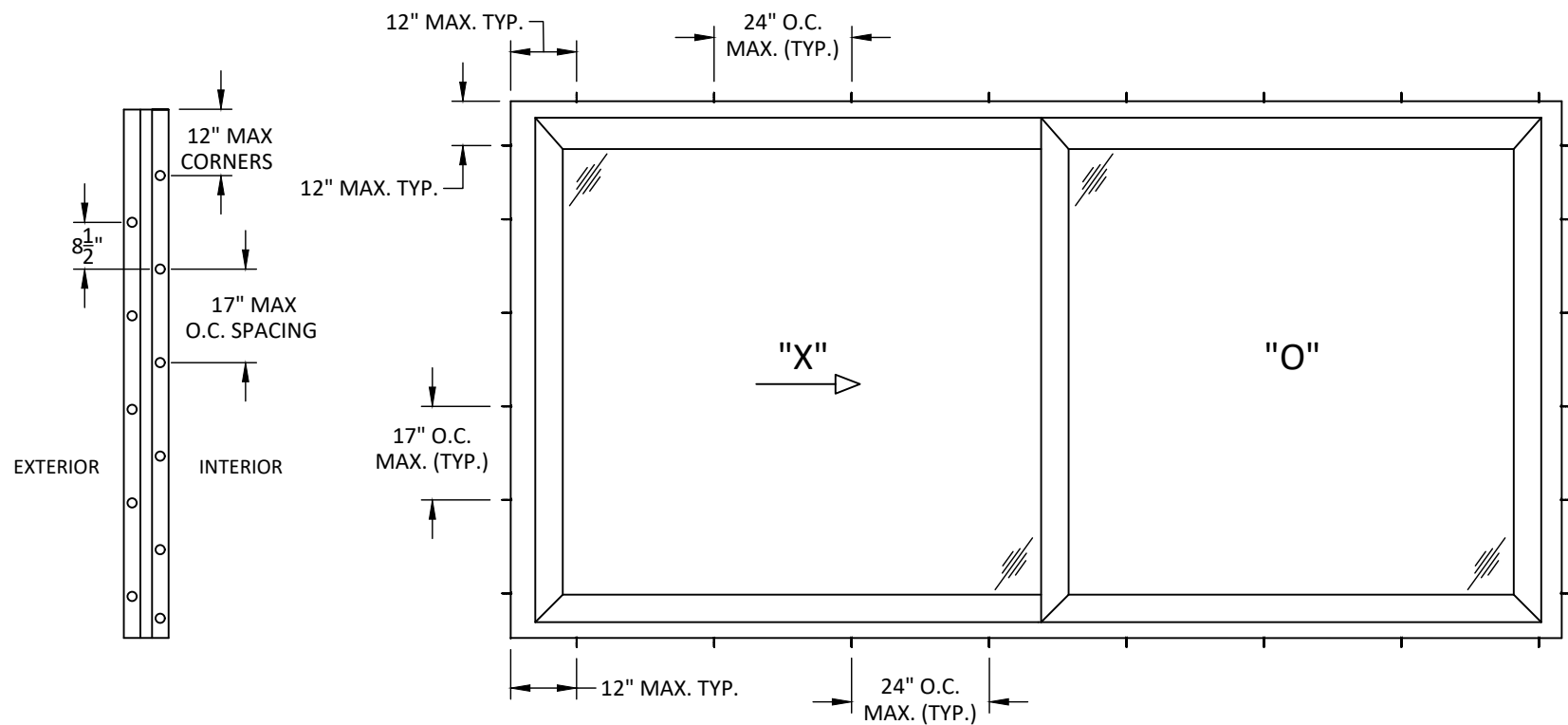
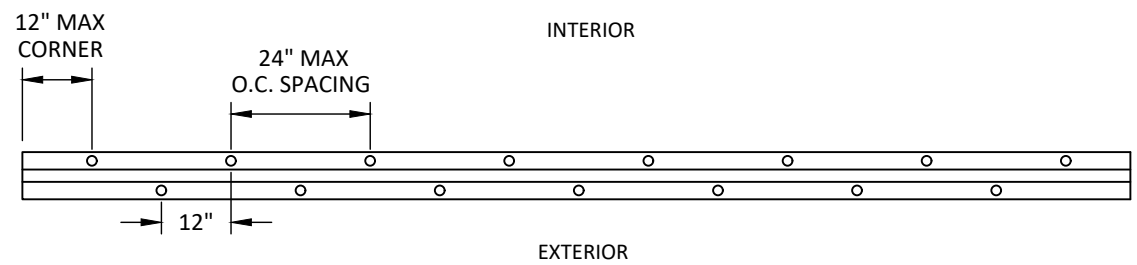

**ANCHOR LAYOUT**  
THROUGH FRAME ANCHORS  
TYPICAL FOR QUALIFIED CONFIGURATIONS  
(OX, XO, XX, XOX, OXO, OXX, XXO, OXXO)

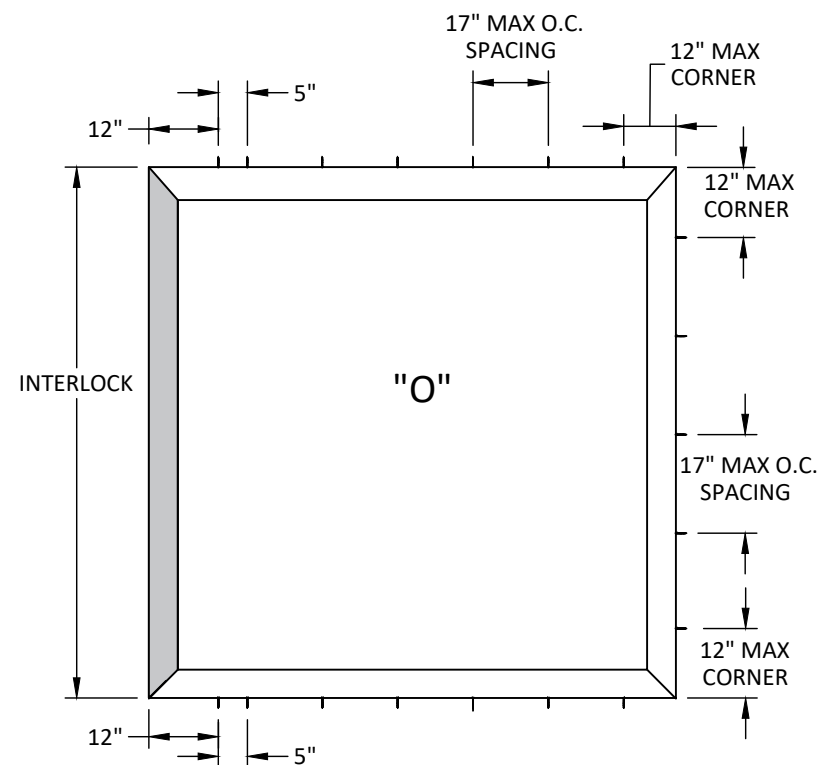

**FIXED PANEL ASSEMBLY**  
SCREWS ON FIXED WINDOW ARE ATTACHED TO  
STEEL REINFORCEMENT LOCATED IN THE FRAME.  
TYPICAL FOR QUALIFIED CONFIGURATIONS  
(OX, XO, XX, XOX, OXO, OXX, XXO, OXXO)



7905 NW 77TH AVE  
MEDLEY, FL 33166  
PH: (305) 888-5718 FX: (305) 220-5073

TITLE: 88MD LIFT AND SLIDE DOOR  
(HVHZ)(IMPACT)

ANCHOR LAYOUTS

PREPARED BY:   
**BUILDING DROPS, INC.**  
398 E. DANIA BEACH BLVD., STE. 338  
DANIA BEACH, FL 33004  
PH: (954) 399-8478  
FAX: (954) 744-4738  
WEB: www.buildingdrops.com

| REMARKS            | BY | DATE  |
|--------------------|----|-------|
| A-CODE CHANGE 2020 | YC | 09/20 |
|                    |    |       |
|                    |    |       |
|                    |    |       |

THE INSTALLATION DETAILS DESCRIBED HERE IN ARE GENERIC AND MAY NOT REFLECT ACTUAL CONDITIONS FOR A SPECIFIC SITE. IF SITE CONDITIONS CAUSE INSTALLATION TO DEVIATE FROM THE REQUIREMENTS DETAILED HEREIN, A LICENSED ENGINEER OR ARCHITECT SHALL PREPARE SITE SPECIFIC DOCUMENTS FOR USE WITH THIS DOCUMENT.

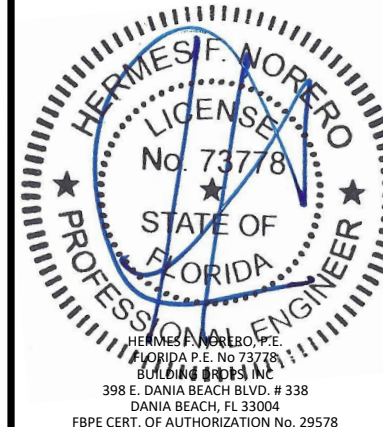

FL #: **FL12092**

DATE: **09.29.2020**

DWG. BY: **YC** CHK. BY: **HFN**

SCALE: **NTS**

DWG. #: **ECI010**

SHEET:

**4**

OF 9



c:\users\p50\onedrive - building drops, inc\ec010.dwg 1/11/2021 12:42 PM

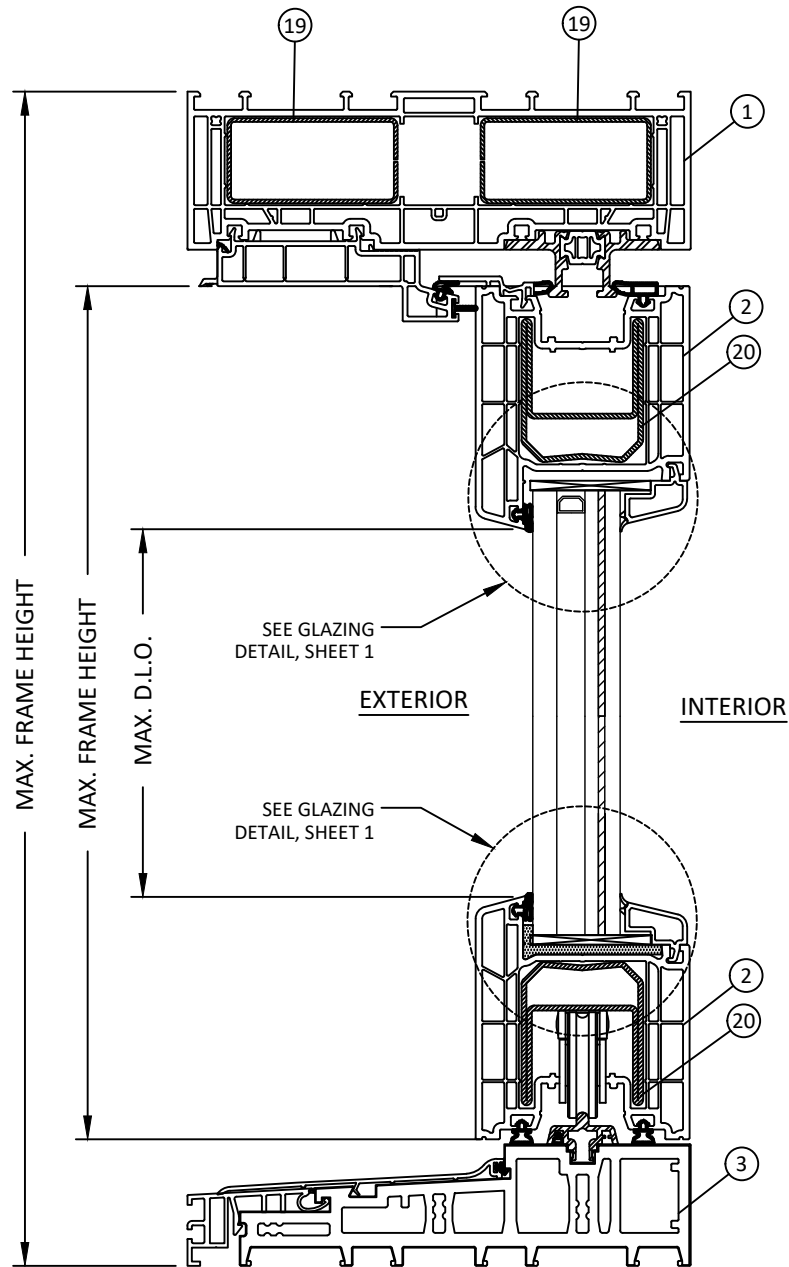

**A**  
**5** **VERTICAL SECTION**  
LIFT AND SLIDE  
"OPERABLE"

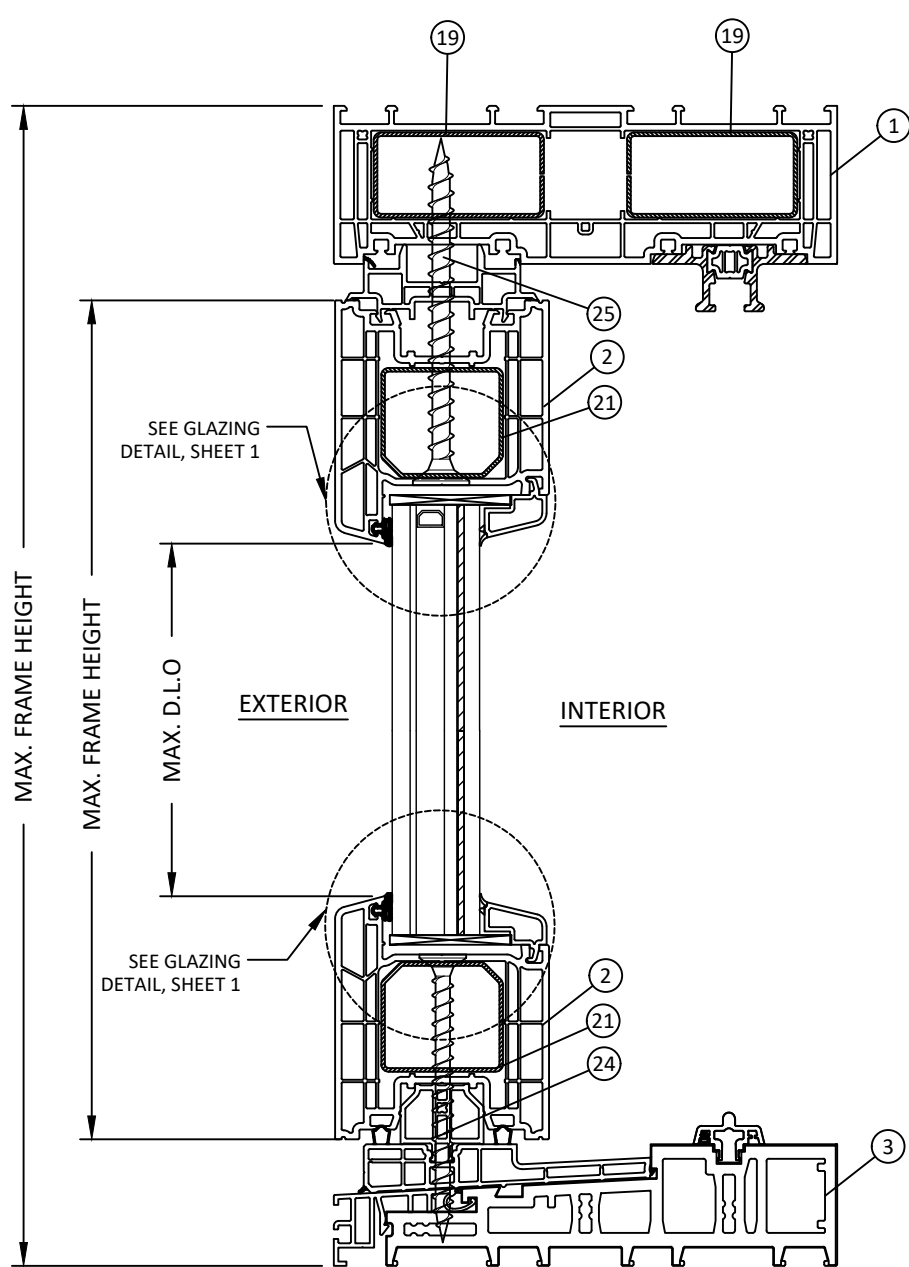

**B**  
**5** **VERTICAL SECTION**  
LIFT AND SLIDE  
"FIXED"

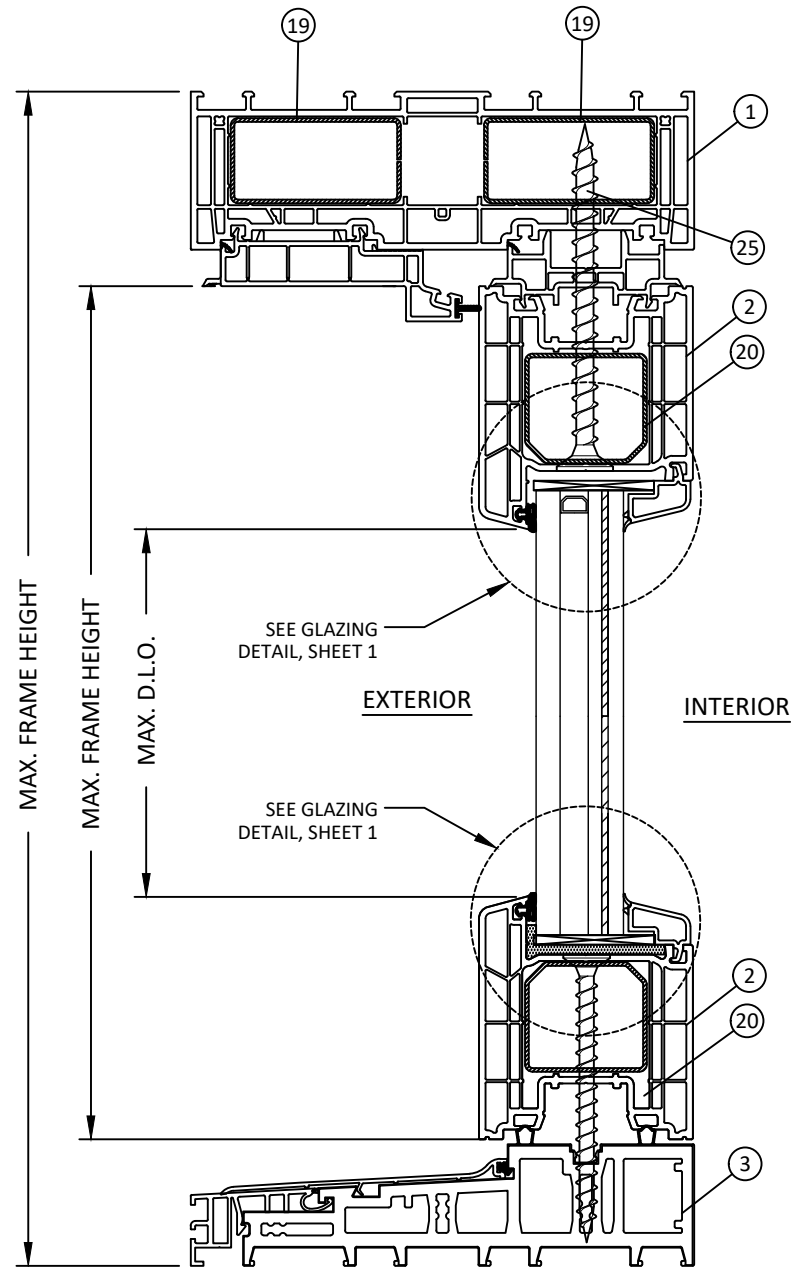

**C**  
**5** **VERTICAL SECTION**  
LIFT AND SLIDE  
"FIXED"



7905 NW 77TH AVE  
MEDLEY, FL 33166  
PH: (305) 888-5718 FX: (305) 220-5073

TITLE: 88MD LIFT AND SLIDE DOOR  
(HVHZ)(IMPACT)

VERTICAL SECTIONS

PREPARED BY:

**BUILDING DROPS, INC.**  
398 E. DANIA BEACH BLVD., STE. 338  
DANIA BEACH, FL 33004  
PH: (954) 399-8478  
FAX: (954) 744-4738  
WEB: www.buildingdrops.com



| REMARKS            | BY | DATE  |
|--------------------|----|-------|
| A-CODE CHANGE 2020 | YC | 09/20 |
|                    |    |       |
|                    |    |       |

THE INSTALLATION DETAILS DESCRIBED HEREIN ARE GENERIC AND MAY NOT REFLECT ACTUAL CONDITIONS FOR A SPECIFIC SITE. IF SITE CONDITIONS CAUSE INSTALLATION TO DEVIATE FROM THE REQUIREMENTS DETAILED HEREIN, A LICENSED ENGINEER OR ARCHITECT SHALL PREPARE SITE SPECIFIC DOCUMENTS FOR USE WITH THIS DOCUMENT.

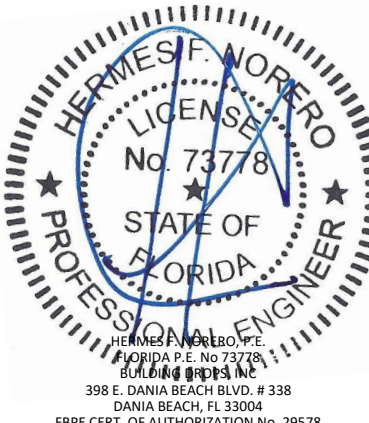

|          |                   |
|----------|-------------------|
| FL #:    | <b>FL12092</b>    |
| DATE:    | <b>09.29.2020</b> |
| DWG. BY: | <b>YC</b>         |
| CHK. BY: | <b>HFN</b>        |
| SCALE:   | <b>NTS</b>        |
| DWG. #:  | <b>ECI010</b>     |
| SHEET:   | <b>5</b>          |

1/11/2021 12:42 PM  
c:\users\p50\onedrive - building drops, inc\ec010.dwg

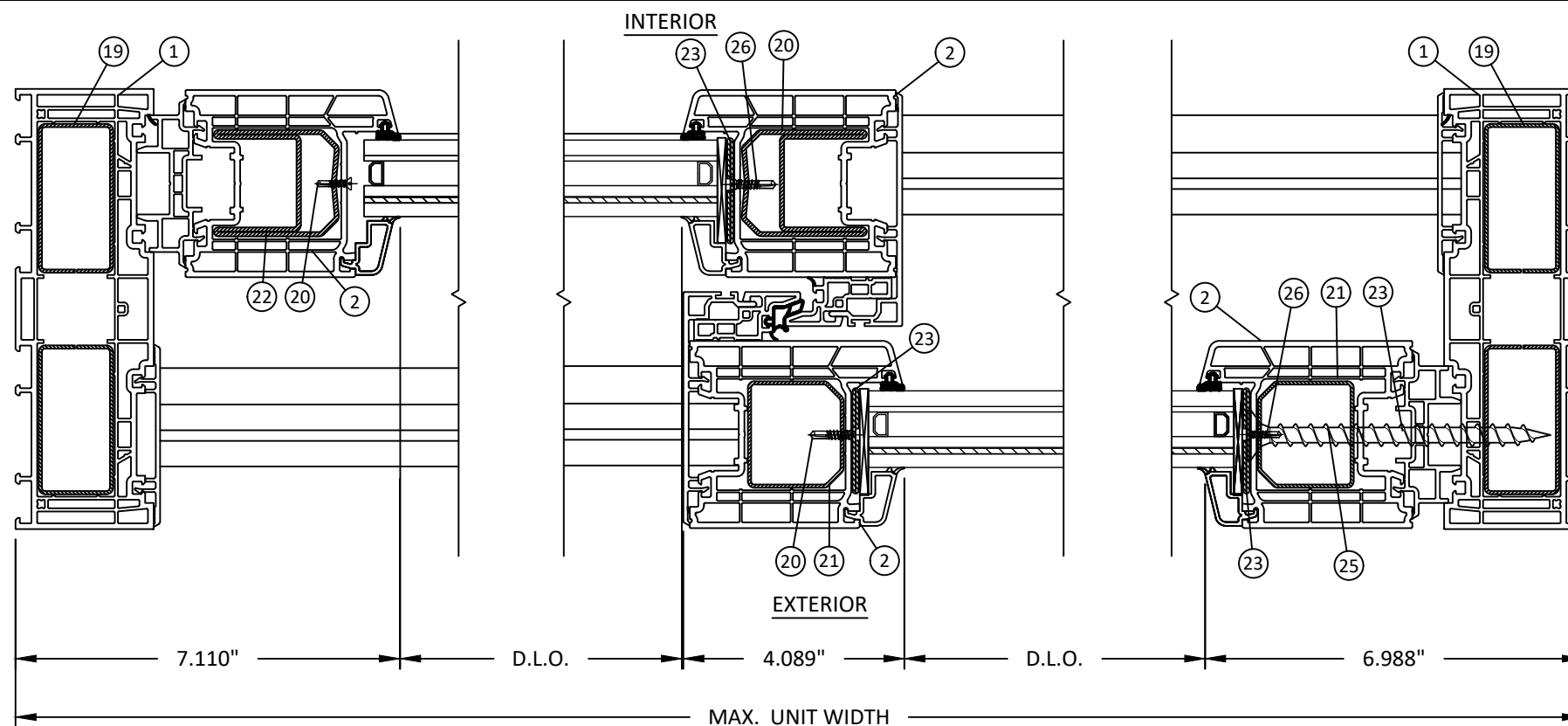

**A** HORIZONTAL SECTION  
6 2-PANEL LIFT AND SLIDE

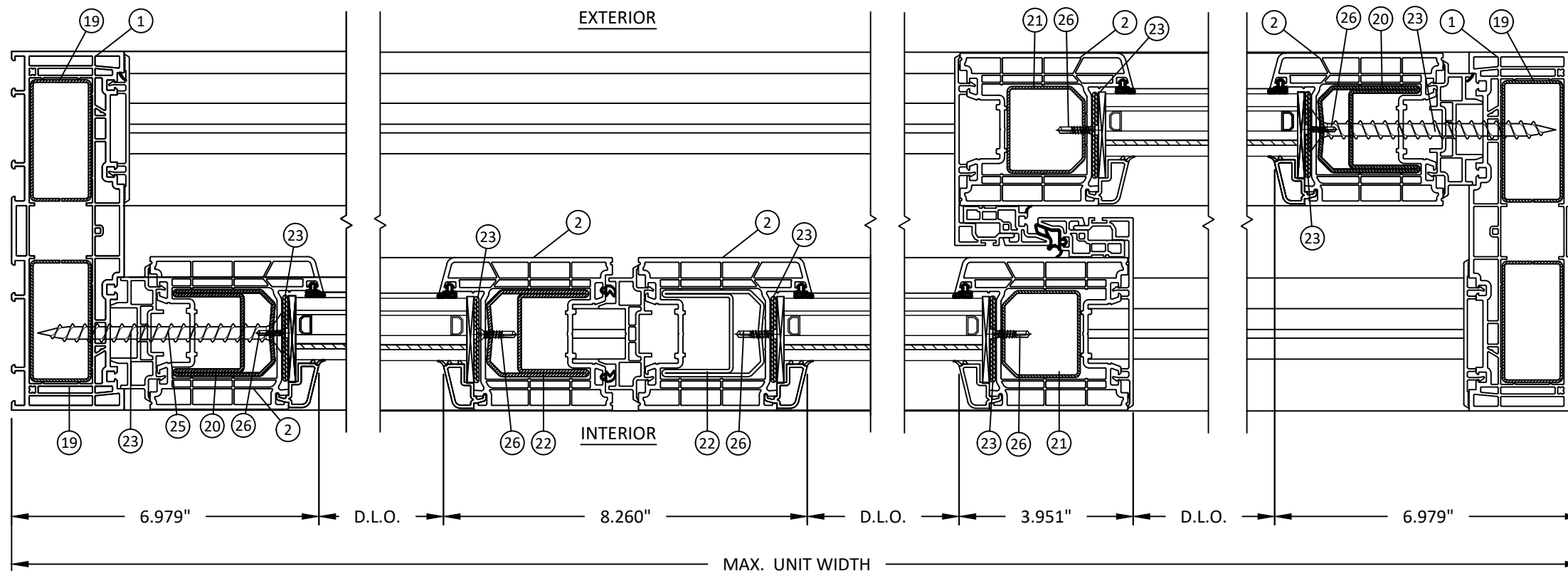

**B** HORIZONTAL SECTION  
6 3-PANEL LIFT AND SLIDE



7905 NW 77TH AVE  
MEDLEY, FL 33166  
PH: (305) 888-5718 FX: (305) 220-5073

TITLE: 88MD LIFT AND SLIDE DOOR  
(HVHZ)(IMPACT)

HORIZONTAL SECTIONS

PREPARED BY:  
BUILDING DROPS, INC.  
398 E. DANIA BEACH BLVD., STE. 338  
DANIA BEACH, FL 33004  
PH: (954) 399-8478  
FAX: (954) 744-4738  
WEB: www.buildingdrops.com



| REMARKS            | BY | DATE  |
|--------------------|----|-------|
| A-CODE CHANGE 2020 | YC | 09/20 |
|                    |    |       |
|                    |    |       |
|                    |    |       |

THE INSTALLATION DETAILS DESCRIBED HEREIN ARE GENERIC AND MAY NOT REFLECT ACTUAL CONDITIONS FOR A SPECIFIC SITE. IF SITE CONDITIONS CAUSE INSTALLATION TO DEVIATE FROM THE REQUIREMENTS DETAILED HEREIN, A LICENSED ENGINEER OR ARCHITECT SHALL PREPARE SITE SPECIFIC DOCUMENTS FOR USE WITH THIS DOCUMENT.

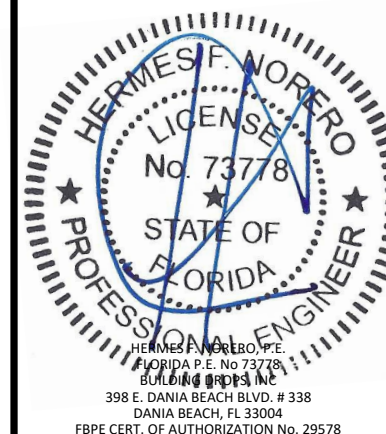

FL #:  
**FL12092**

DATE: **09.29.2020**

DWG. BY: **YC** CHK. BY: **HFN**

SCALE: **NTS**

DWG. #: **ECI010**

SHEET:

6

OF 9

1/11/2021 12:42 PM

c:\users\p50\onedrive - building drops, inc\ecio10.dwg

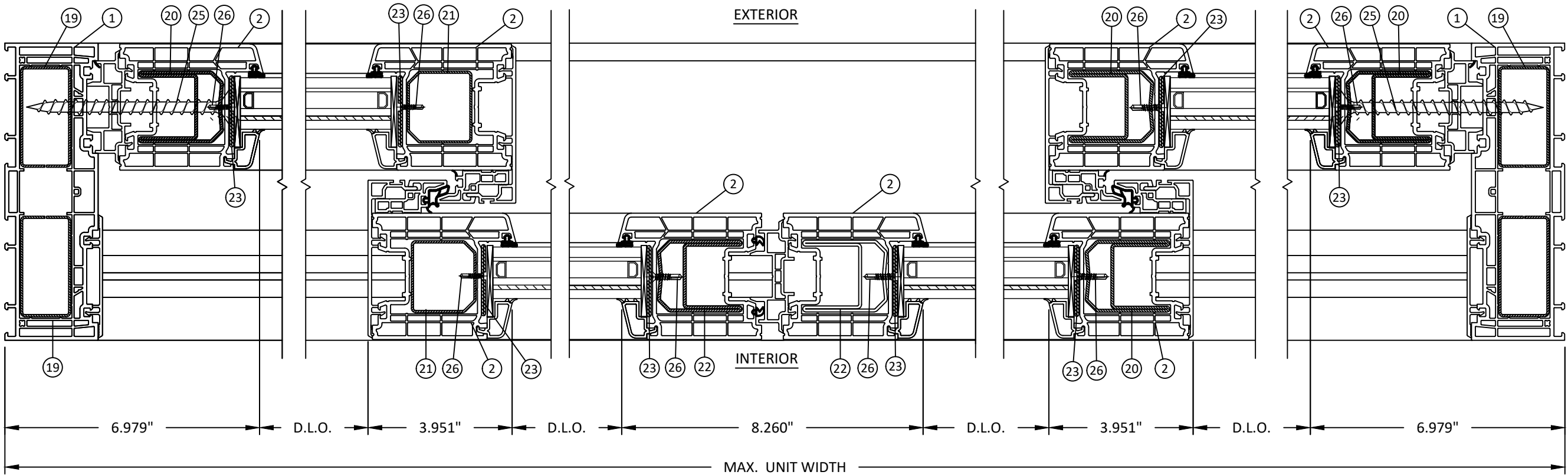

INSTALLATION NOTES:

- ONE (1) INSTALLATION ANCHOR IS REQUIRED AT EACH ANCHOR LOCATION SHOWN.
- THE NUMBER OF INSTALLATION ANCHORS DEPICTED IS THE MINIMUM NUMBER OF ANCHORS TO BE USED FOR PRODUCT INSTALLATION OF THE MAXIMUM SIZE LISTED.
- INSTALL INDIVIDUAL INSTALLATION ANCHORS WITHIN A TOLERANCE OF  $\pm 1/4$  INCH THE DEPICTED LOCATION & SPACING IN THE ANCHOR LAYOUT DETAILS (I.E., WITHOUT CONSIDERATION OF TOLERANCES). TOLERANCES ARE NOT CUMULATIVE FROM ONE INSTALLATION ANCHOR TO THE NEXT.
- SHIM AS REQUIRED AT EACH INSTALLATION ANCHOR WITH LOAD BEARING SHIM(S). MAXIMUM ALLOWABLE SHIM STACK TO BE 1/4 INCH. SHIM WHERE SPACE OF 1/16 INCH OR GREATER OCCURS. SHIM(S) SHALL BE CONSTRUCTED OF HIGH DENSITY PLASTIC OR BETTER.
- FOR MASONRY OR CONCRETE OPENINGS, A 1X WOOD BUCK MAY BE USED (OPTIONAL) AS LONG AS THE MINIMUM EMBEDMENT AND EDGE DISTANCE REQUIREMENTS ARE STILL MET WITHIN THE CORRESPONDING HOST SUBSTRATE. SEE GENERAL NOTE #3 ON SHEET 1 FOR MORE INFORMATION.
- MINIMUM EMBEDMENT AND EDGE DISTANCE EXCLUDE WALL FINISHES, INCLUDING BUT NOT LIMITED TO STUCCO, FOAM, BRICK VENEER, AND SIDING.
- INSTALLATION ANCHORS AND ASSOCIATED HARDWARE MUST BE MADE OF CORROSION RESISTANT MATERIAL OR HAVE A CORROSION RESISTANT COATING.
- FOR HOLLOW BLOCK AND GROUT FILLED BLOCK, DO NOT INSTALL INSTALLATION ANCHORS INTO MORTAR JOINTS. EDGE DISTANCE IS MEASURED FROM FREE EDGE OF BLOCK OR EDGE OF MORTAR JOINT INTO FACE SHELL OF BLOCK.
- INSTALLATION ANCHORS SHALL BE INSTALLED IN ACCORDANCE WITH ANCHOR MANUFACTURER'S INSTALLATION INSTRUCTIONS, AND ANCHORS SHALL NOT BE USED IN SUBSTRATES WITH STRENGTHS LESS THAN THE MINIMUM STRENGTH SPECIFIED BY THE ANCHOR MANUFACTURER.

**A**  
**7** **HORIZONTAL SECTION**  
**4-PANEL LIFT AND SLIDE**

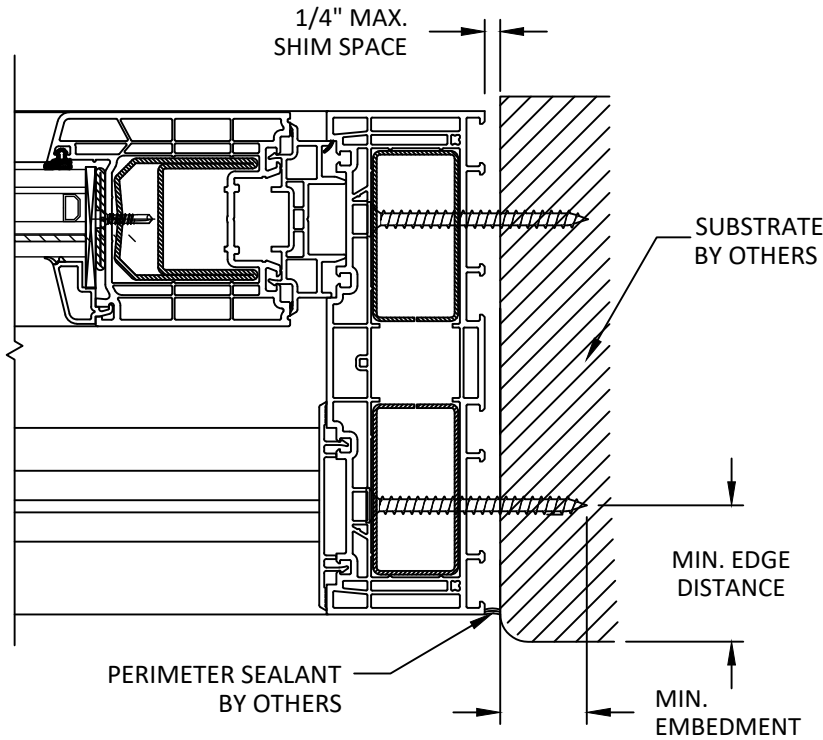

**B**  
**7** **HORIZONTAL SECTION**  
**THROUGH FRAME (JAMB)**

| ANCHOR SCHEDULE |  |                          |  |                    |
|-----------------|--|--------------------------|--|--------------------|
| METHOD          | SUBSTRATE  | ANCHOR SCHEDULE          | MIN EMBEDMENT                          | MIN. EDGE DISTANCE |
| THROUGH FRAME   | WOOD: MIN. SG = 0.55                               | #14 WOOD SCREW FLAT HEAD | 1.5"                                   | 0.75"              |
|                 | METAL: 18 GAUGE Steel, MIN. Fy = 33KSI             | 1/4" TEK SCREW FLAT HEAD | 3 THREADS MIN PENETRATION BEYOND METAL | 0.5"               |
|                 | METAL: ALUMINUM MIN. 1/8" THICKNESS (6063-T5 MIN.) | 1/4" TEK SCREW FLAT HEAD | 3 THREADS MIN PENETRATION BEYOND METAL | 0.5"               |
|                 | CONCRETE: MIN. f'c=3000PSI                         | 1/4" ITW TAPCON FLATHEAD | 1.25"                                  | 2.0                |
|                 | MASONRY: CMU per ASTM C90 MIN. 2000 PSI            | 1/4" ITW TAPCON FLATHEAD | 1"                                     | 2.0                |



7905 NW 77TH AVE  
MEDLEY, FL 33166  
PH: (305) 888-5718 FX: (305) 220-5073

TITLE: 88MD LIFT AND SLIDE DOOR  
(HVHZ)(IMPACT)

INSTALLATION NOTES,  
REINFORCEMENT  
& ANCHOR DETAILS

PREPARED BY:

**BUILDING DROPS, INC.**  
398 E. DANIA BEACH BLVD., STE. 338  
DANIA BEACH, FL 33004  
PH: (954) 399-8478  
FAX: (954) 744-4738  
WEB: www.buildingdrops.com



| REMARKS            | BY | DATE  |
|--------------------|----|-------|
| A-CODE CHANGE 2020 | YC | 09/20 |
|                    |    |       |
|                    |    |       |
|                    |    |       |

THE INSTALLATION DETAILS DESCRIBED HERE IN ARE GENERIC AND MAY NOT REFLECT ACTUAL CONDITIONS FOR A SPECIFIC SITE. IF SITE CONDITIONS CAUSE INSTALLATION TO DEVIATE FROM THE REQUIREMENTS DETAILED HEREIN, A LICENSED ENGINEER OR ARCHITECT SHALL PREPARE SITE SPECIFIC DOCUMENTS FOR USE WITH THIS DOCUMENT.

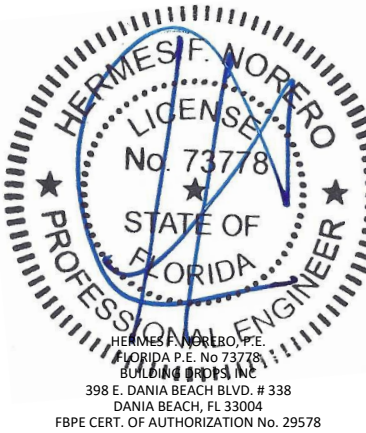

FL #:  
**FL12092**  
DATE: **09.29.2020**  
DWG. BY: **YC** CHK. BY: **HFN**  
SCALE: **NTS**  
DWG. #: **ECIO10**  
SHEET:

7



1/11/2021 12:42 PM

c:\users\p50\onedrive - building drops, inc\eci010.dwg

| GLASS LOAD CAPACITY (PSF) |        |                        |                        |
|---------------------------|--------|------------------------|------------------------|
| PANEL NOMINAL SIZE (IN)   |        | GLASS TYPE 1-4         | GLASS TYPE 5           |
| WIDTH                     | HEIGHT | "EXT. (+)<br>INT. (-)" | "EXT. (+)<br>INT. (-)" |
| 24                        | 84     | 120.0                  | 55.0                   |
| 30                        |        | 120.0                  | 55.0                   |
| 36                        |        | 120.0                  | 55.0                   |
| 42                        |        | 120.0                  | 55.0                   |
| 48                        |        | 120.0                  | 55.0                   |
| 54                        |        | 120.0                  | 55.0                   |
| 60                        |        | 116.0                  | 55.0                   |
| 66                        |        | 105.5                  | 55.0                   |
| 72                        |        | 96.7                   | 55.0                   |
| 78                        |        | 89.2                   | 55.0                   |
| 84                        | 90     | --                     | 55.0                   |
| 90                        |        | --                     | 55.0                   |
| 96                        |        | --                     | 55.0                   |
| 24                        |        | 120.0                  | 55.0                   |
| 30                        |        | 120.0                  | 55.0                   |
| 36                        |        | 120.0                  | 55.0                   |
| 42                        |        | 120.0                  | 55.0                   |
| 48                        |        | 120.0                  | 55.0                   |
| 54                        |        | 120.0                  | 55.0                   |
| 60                        |        | 116.0                  | 55.0                   |
| 66                        | 96     | 105.5                  | 55.0                   |
| 72                        |        | 96.7                   | 55.0                   |
| 78                        |        | --                     | 55.0                   |
| 84                        |        | --                     | 55.0                   |
| 90                        |        | --                     | 55.0                   |
| 96                        |        | --                     | 55.0                   |
| 24                        |        | 120.0                  | 55.0                   |
| 30                        |        | 120.0                  | 55.0                   |
| 36                        |        | 120.0                  | 55.0                   |
| 42                        |        | 120.0                  | 55.0                   |
| 48                        | 102    | 120.0                  | 55.0                   |
| 54                        |        | 116.0                  | 55.0                   |
| 60                        |        | 105.5                  | 55.0                   |
| 66                        |        | --                     | 55.0                   |
| 72                        |        | --                     | 55.0                   |
| 78                        |        | --                     | 54.8                   |
| 84                        |        | --                     | 51.9                   |

| GLASS LOAD CAPACITY (PSF) |        |                        |                        |
|---------------------------|--------|------------------------|------------------------|
| PANEL NOMINAL SIZE (IN)   |        | GLASS TYPE 1-4         | GLASS TYPE 5           |
| WIDTH                     | HEIGHT | "EXT. (+)<br>INT. (-)" | "EXT. (+)<br>INT. (-)" |
| 24                        | 108    | 120.0                  | 55.0                   |
| 30                        |        | 120.0                  | 55.0                   |
| 36                        |        | 120.0                  | 55.0                   |
| 42                        |        | 120.0                  | 55.0                   |
| 48                        |        | 120.0                  | 55.0                   |
| 54                        |        | 120.0                  | 55.0                   |
| 60                        |        | 116.0                  | 55.0                   |
| 66                        |        | --                     | 55.0                   |
| 72                        |        | --                     | 51.0                   |
| 78                        |        | --                     | 47.0                   |
| 24                        | 114    | 120.0                  | 55.0                   |
| 30                        |        | 120.0                  | 55.0                   |
| 36                        |        | 120.0                  | 55.0                   |
| 42                        |        | 120.0                  | 55.0                   |
| 48                        |        | 120.0                  | 55.0                   |
| 54                        |        | 120.0                  | 55.0                   |
| 60                        |        | 116.0                  | 52.0                   |
| 66                        |        | --                     | 47.3                   |
| 72                        |        | --                     | 43.3                   |
| 24                        | 120    | 120.0                  | 55.0                   |
| 30                        |        | 120.0                  | 55.0                   |
| 36                        |        | 120.0                  | 55.0                   |
| 42                        |        | 120.0                  | 55.0                   |
| 48                        |        | 120.0                  | 55.0                   |
| 54                        |        | 120.0                  | 49.5                   |
| 60                        |        | --                     | 44.6                   |
| 66                        |        | --                     | 40.5                   |
| 72                        |        | --                     | 37.2                   |

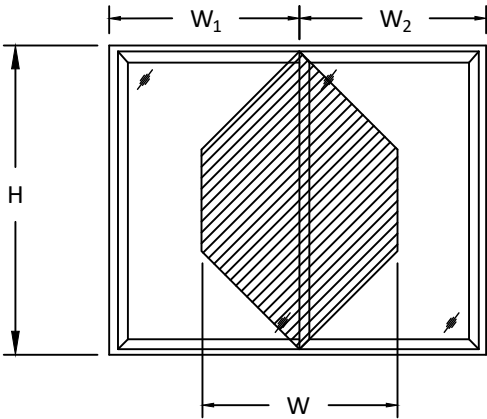

$$W = \frac{W_1 + W_2}{2}$$



7905 NW 77TH AVE  
MEDLEY, FL 33166  
PH: (305) 888-5718 FX: (305) 220-5073

TITLE: 88MD LIFT AND SLIDE DOOR  
(HVHZ)(IMPACT)

GLASS LOAD CAPACITIES

PREPARED BY:

BUILDING DROPS, INC.  
398 E. DANIA BEACH BLVD., STE. 338  
DANIA BEACH, FL 33004  
PH: (954) 399-8478  
FAX: (954) 744-4738  
WEB: www.buildingdrops.com



| REMARKS            | BY | DATE  |
|--------------------|----|-------|
| A-CODE CHANGE 2020 | YC | 09/20 |
|                    |    |       |
|                    |    |       |
|                    |    |       |

THE INSTALLATION DETAILS DESCRIBED HERE IN ARE GENERIC AND MAY NOT REFLECT ACTUAL CONDITIONS FOR A SPECIFIC SITE. IF SITE CONDITIONS CAUSE INSTALLATION TO DEVIATE FROM THE REQUIREMENTS DETAILED HEREIN, A LICENSED ENGINEER OR ARCHITECT SHALL PREPARE SITE SPECIFIC DOCUMENTS FOR USE WITH THIS DOCUMENT.

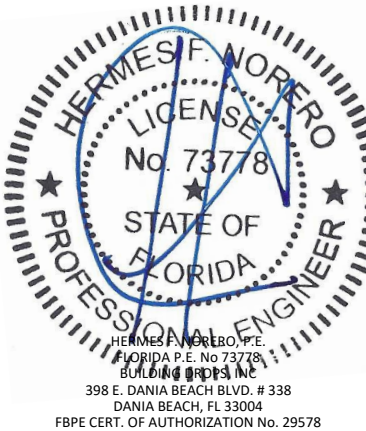

FL #  
**FL12092**

DATE: **09.29.2020**

DWG. BY: **YC** CHK. BY: **HFN**

SCALE: **NTS**

DWG. #: **ECI010**

SHEET:

8



| BILL OF MATERIALS |        |                             |          |
|-------------------|--------|-----------------------------|----------|
| ITEM              | PART # | DESCRIPTION                 | MATERIAL |
| 1                 | 2880   | FRAME                       | VINYL    |
| 2                 | 2883   | SASH                        | VINYL    |
| 3                 | Z042   | THRESHOLD                   | VINYL    |
| 4                 | 2881   | COVER PROFILE               | VINYL    |
| 5                 | 2882   | COVER TRIM                  | VINYL    |
| 6                 | 2884   | SASH BASE                   | VINYL    |
| 7                 | 2885   | SASH EXTENSION              | VINYL    |
| 8                 | 2886   | SASH COVER TRIM             | VINYL    |
| 9                 | 2887   | MIDDLE CONNECTOR            | VINYL    |
| 10                | 2452   | GLAZING BEAD (lam 9/16")    | VINYL    |
| 11                | 76501  | GLAZING BEAD (IG 1 3/16")   | VINYL    |
| 12                | 2661   | GLAZING GASKET (lam 9/16")  | TPV/EPDM |
| 13                | 2658   | GLAZING GASKET (IG 1 3/16") | TPV/EPDM |
| 14                | M085   | SPACER PROFILE              | VINYL    |
| 15                | A001   | GUIDE RAIL TOP              | ALUMINUM |
| 16                | 9S77   | GUIDE RAIL BOTTOM           | ALUMINUM |
| 17                | 9S89   | SASH SEALING PROFILE        | VINYL    |
| 18                | 9S76   | THRESHOLD TOP               | ALUMINUM |
| 19                | V191   | REINFORCEMENT               | STEEL    |
| 20                | V192   | REINFORCEMENT               | STEEL    |
| 21                | V193   | REINFORCEMENT               | STEEL    |
| 22                | V194   | REINFORCEMENT               | STEEL    |
| 23                | V280   | REINFORCEMENT               | STEEL    |
| 24                | -      | EJOT 7.5 X 120 SCREW        | STEEL    |
| 25                | -      | EJOT 7.5 X 135 SCREW        | STEEL    |
| 26                | -      | 3.9" X 19" SCREW            | STEEL    |

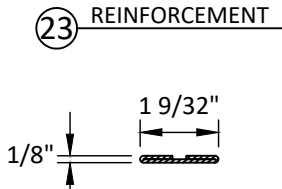
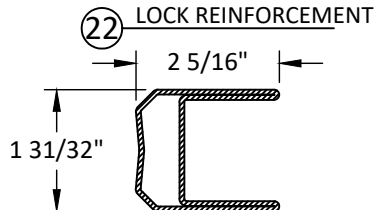
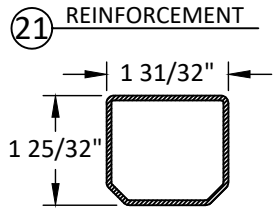
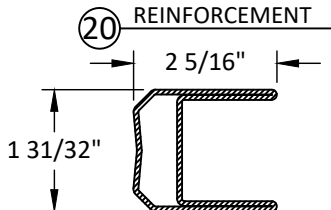
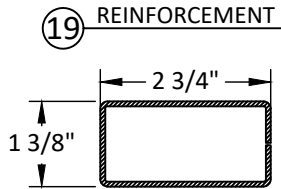
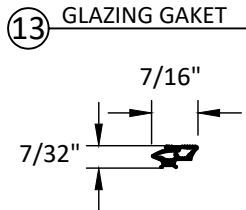
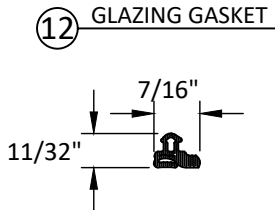
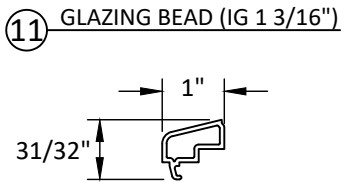
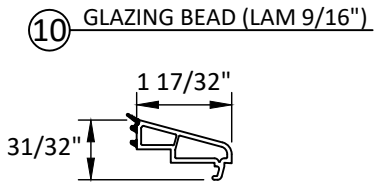
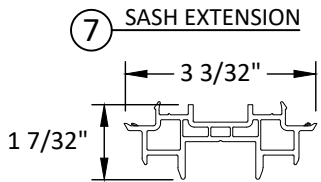
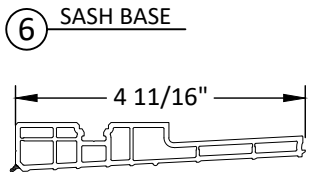
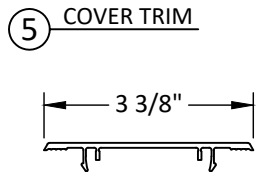
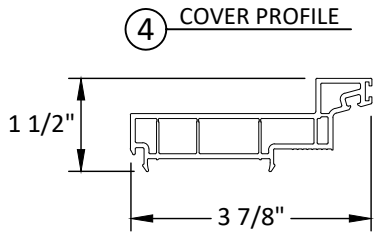
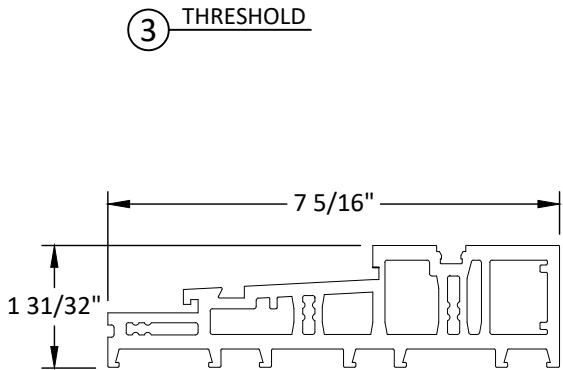
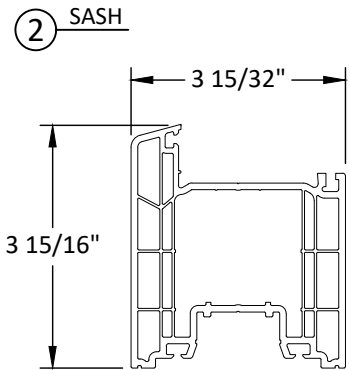
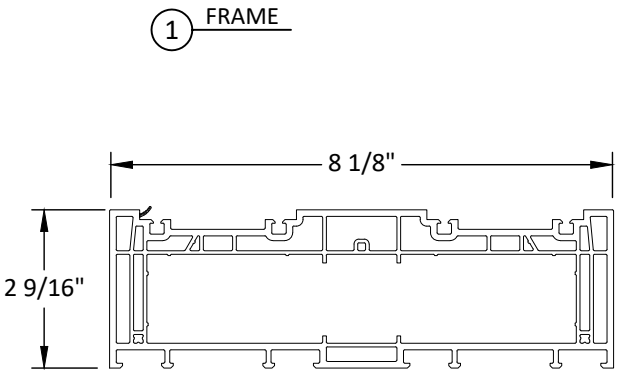

7905 NW 77TH AVE  
MEDLEY, FL 33166  
PH: (305) 888-5718 FX: (305) 220-5073

TITLE: 88MD LIFT AND SLIDE DOOR  
(HVHZ)(IMPACT)

BILL OF MATERIALS

PREPARED BY:

BUILDING DROPS, INC.  
398 E. DANIA BEACH BLVD., STE. 338  
DANIA BEACH, FL 33004  
PH: (954) 399-8478  
FAX: (954) 744-4738  
WEB: www.buildingdrops.com



| REMARKS            | BY | DATE  |
|--------------------|----|-------|
| A-CODE CHANGE 2020 | YC | 09/20 |
|                    |    |       |
|                    |    |       |

THE INSTALLATION DETAILS DESCRIBED HERE IN ARE GENERIC AND MAY NOT REFLECT ACTUAL CONDITIONS FOR A SPECIFIC SITE. IF SITE CONDITIONS CAUSE INSTALLATION TO DEVIATE FROM THE REQUIREMENTS DETAILED HEREIN, A LICENSED ENGINEER OR ARCHITECT SHALL PREPARE SITE SPECIFIC DOCUMENTS FOR USE WITH THIS DOCUMENT.

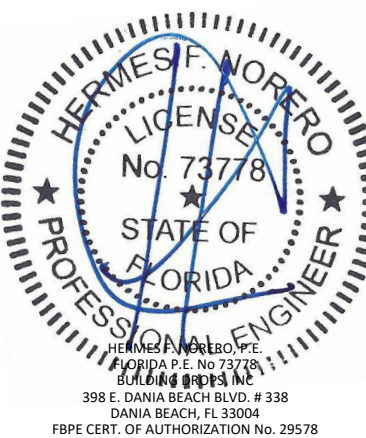

|          |            |
|----------|------------|
| FL #:    | FL12092    |
| DATE:    | 09.29.2020 |
| DWG. BY: | YC         |
| CHK. BY: | HFN        |
| SCALE:   | NTS        |
| DWG. #:  | ECI010     |
| SHEET:   | 9          |